



Cogan
Since 1901



Mezzanines
Increase Floor Space

cogan.com

HANDRAILS

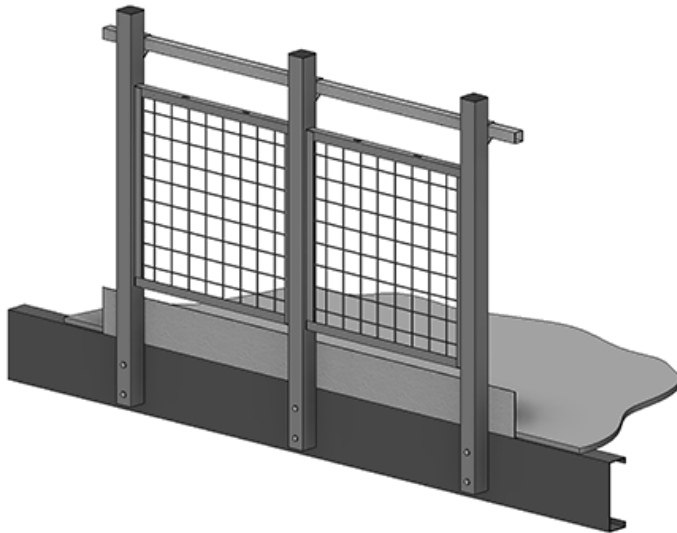

WIRE MESH HANDRAIL

Description

Cogan wire mesh handrails are our upgraded system designed to meet the stringent safety requirements of mezzanines intended for public use. Panels are made of 2"x2" welded wire mesh and are shop welded to 1 1/4"x1 1/4" structural steel frames. Handrail posts are made of 2 1/2"x2 1/2" steel tube. Rails are made of 1 1/2"x1 1/2" steel tube and simply fasten to the posts using specially designed zinc-plated clips. This allows for the rails to be cut to size and attached without welding, reducing installation time and cost. Kick plate is also available.

w.w.Cannon, Inc.

Design. Layout. Build. Install.

1-800-442-3061

www.wwcannon.com

PRODUCT INFORMATION

Specifications

| | |
|------------------|---|
| Post Height | 42" |
| Post Material | Hollow Structural Tubing 2 1/2" x 2 1/2" x 14GA |
| Post Finish | Powder-coated |
| Rail Height | 4" |
| Rail Material | Hollow Structural Tubing 1 1/2" x 1 1/2" x 16GA |
| Rail Finish | Galvanized |
| Wire Mesh Size | 2" x 2" Welded Steel Wire Mesh |
| Frame Material | Structural Angle 1 1/4" x 1 1/4" x 12GA |
| Wire Mesh Finish | Powder-coated |

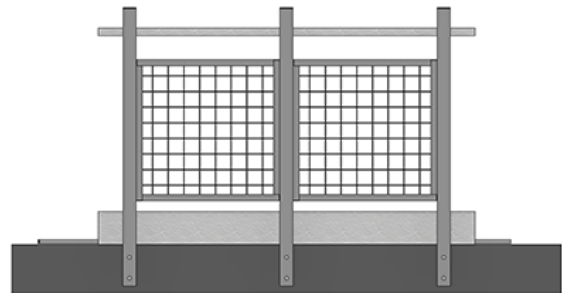

COLORS



Cogan Grey
(Posts and Framed
Mesh Panels)

Electro-Galvanized
(Rails and Kickplate)



SIZES

WIRE MESH HANDRAIL

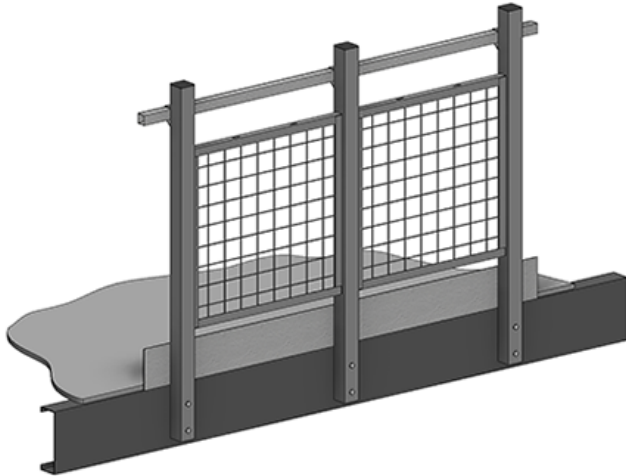

SUMMARY OF STANDARD SIZES

| Description | Size (H") | ITEM# |
|--------------------|-----------|-------|
| Standard Handrail | 42" | MR4 |
| Standard Kickplate | 4" | MR1 |

** CUSTOM HEIGHTS ARE ALSO AVAILABLE

DETAILS

CONNECTION WITH EXISTING MEZZANINE
(CORRUGATED STEEL DECK FLOORING)

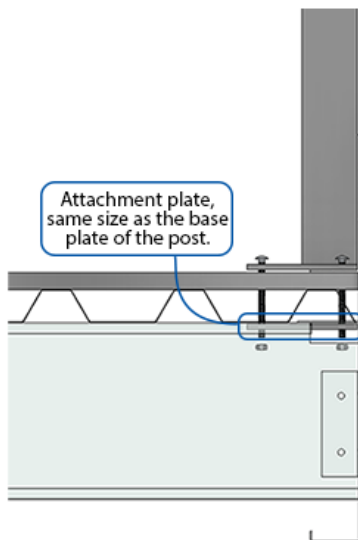

CONNECTION WITH EXISTING MEZZANINE
(CONCRETE FLOORING)

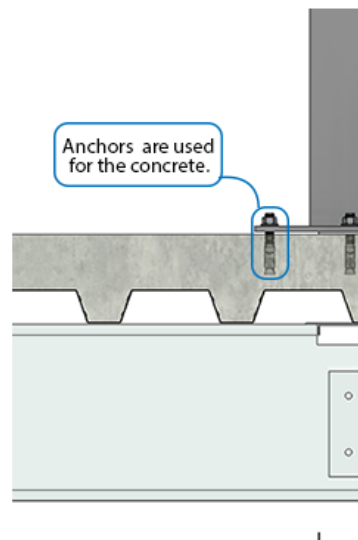

CONNECTION WITH COGAN'S MEZZANINE

