



HIGH  
SPEED  
DOORS



15° MOTOR COVER HOOD



ANTI - DRIP  
PATENTED

DynaDry

# TECHNICAL DATA



ANTI-DRIP



WATER DISCHARGE



WASHABLE



HIGH SAFETIES



SELF-REPAIR



OIL FREE



GRAVITY TECHNOLOGY

MAXIMUM DIMENSIONS	W 6500 mm x H 6500 mm
SPEED	Up to 2,5 m/s
CYCLES TEST	1.000.000
AIR PERMEABILITY	3000 x 3000 Class 3 5000 x 5000 Class 2
STRUCTURE	Not self-supporting
FRAME / MOTOR COVER HOOD	<b>Standard</b> Galvanized steel Stainless Steel 441/304
CURTAIN	<b>Standard</b> PVC curtain 900 gr/m <sup>2</sup>
	<b>Optional</b> • Translucent 35/40% • FDA (white) • Antistatic
SLIDING SYSTEM	Patented sliding system with high density Polyzene self-lubricant equipped of sliding zipper directly on curtain
CONTROL PANEL	<b>Standard</b> PVC panel (300 x 400 x 150 mm)
	<b>Optional</b> • Stainless steel • Coated steel panel IP54 (300 x 500 x 150 mm)
	Inverter 50/60 Hz with absolute encoder
	Power supply 1-ph, 230V max 16A
	Power supply 3-ph, 400V max 10A
	Power supply 3-ph, 230V max 16A
	Start/ Stop button
	2 free contacts (door open / closed / alarm)
	Automatic/Manual Interlocking between 2 doors
IP54 rating for motor and control panel	
WIRING	Plug and Play system IP65
SAFETIES	<b>Standard</b> • IP65 photocells set • Anti-jam sensor reverse
	<b>Optional</b> • WiFi safety edge IP65 • Multi ray light curtain barrier H 2500 IP67
EMERGENCY OPENING	<b>Standard</b> Hand crank
	<b>Optional</b> Chain system UPS Battery
ADVISING OPERATIVE TEMPERATURE	Operating till - 30 °C with addition of heating kit - Not adapt to be installed in negative / positive temperature

The **DynamicRoll® DynaDry** features a stainless steel construction and is designed to prevent condensation and water from falling into the passageway when the door is open. The door, with its patented and innovative system, protects the goods passing under the passageway and is designed to be easily washable in all its parts while meeting the hygiene criteria required by the industry.

## EN13241 CERTIFICATION

STANDARD	RIF.	TEST ACC.	RESULTS
WATER PERMEABILITY	EN 12425	EN 12489	Class 1
WIND LOAD	EN 12424	EN 12444	Up to Class 3
WIND PERMEABILITY	EN 12426	EN 12427	Class 2
SAFE OPENINGS	EN 12453	EN 12445	✓
MECHANICAL RESISTANCE	EN 12604	EN 12605	✓
UNINTENDED MOVEMENTS	EN 12604	EN 12605	✓
THERMAL TRANSMITTANCE	EN 12428	EN 12428	6,02 W/m <sup>2</sup> K
PERFORMANCE (CYCLES)	EN 12604	EN 12605	1.000.000

Values can change depending on door dimensions

# ADVANTAGES

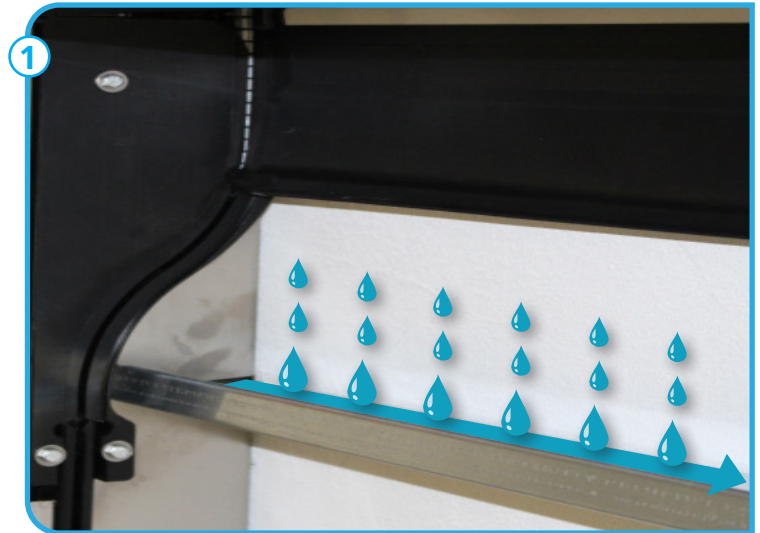
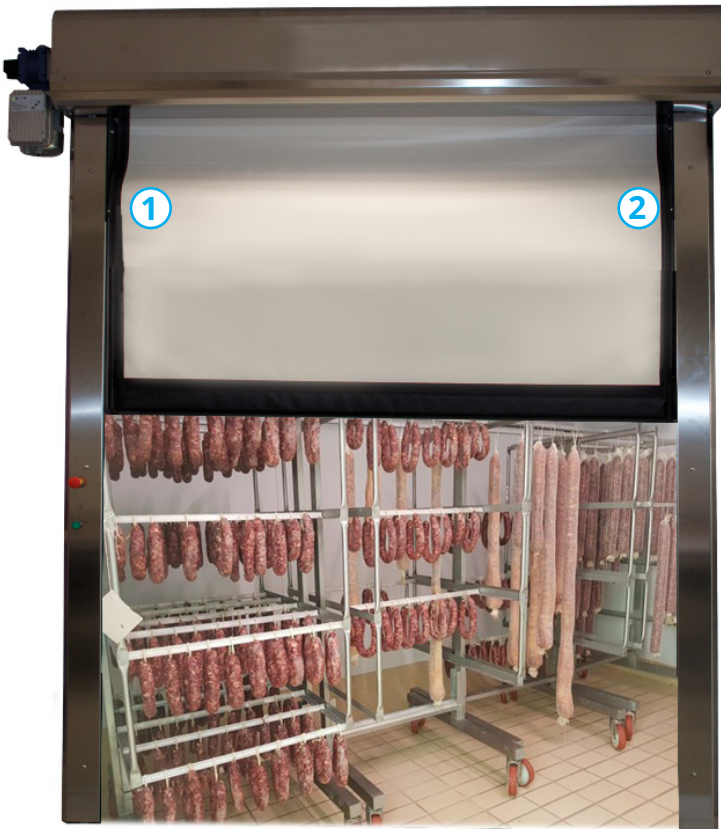

- Patented system
- Anti-drip

- Hygienic
- Fast
- Hermetic
- Silent
- 100% safe with no rigid elements in the mantle
- Plug & Play (ease of installation)
- Low maintenance
- Energy-saving
- Easily washable
- Self-repairing

## SLIDING SYSTEM / SELF-REPAIRING



# DOOR SPACE REQUIREMENTS

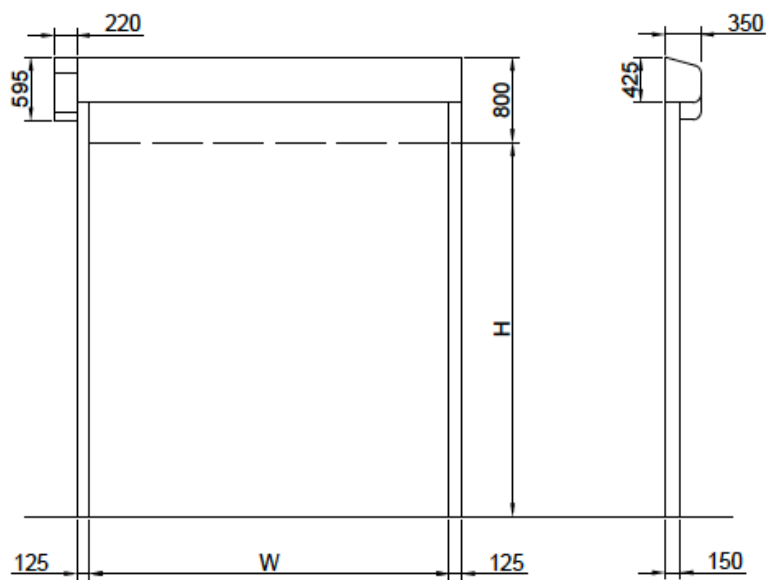
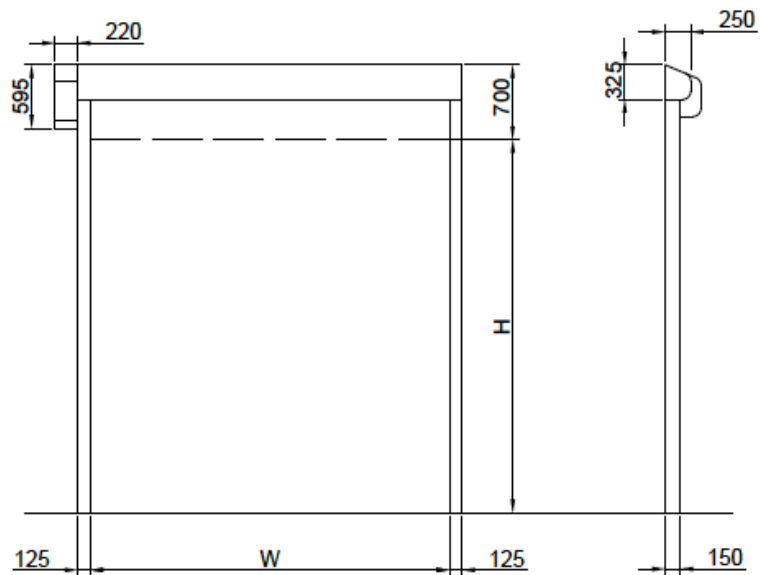

## FIXING DETAILS

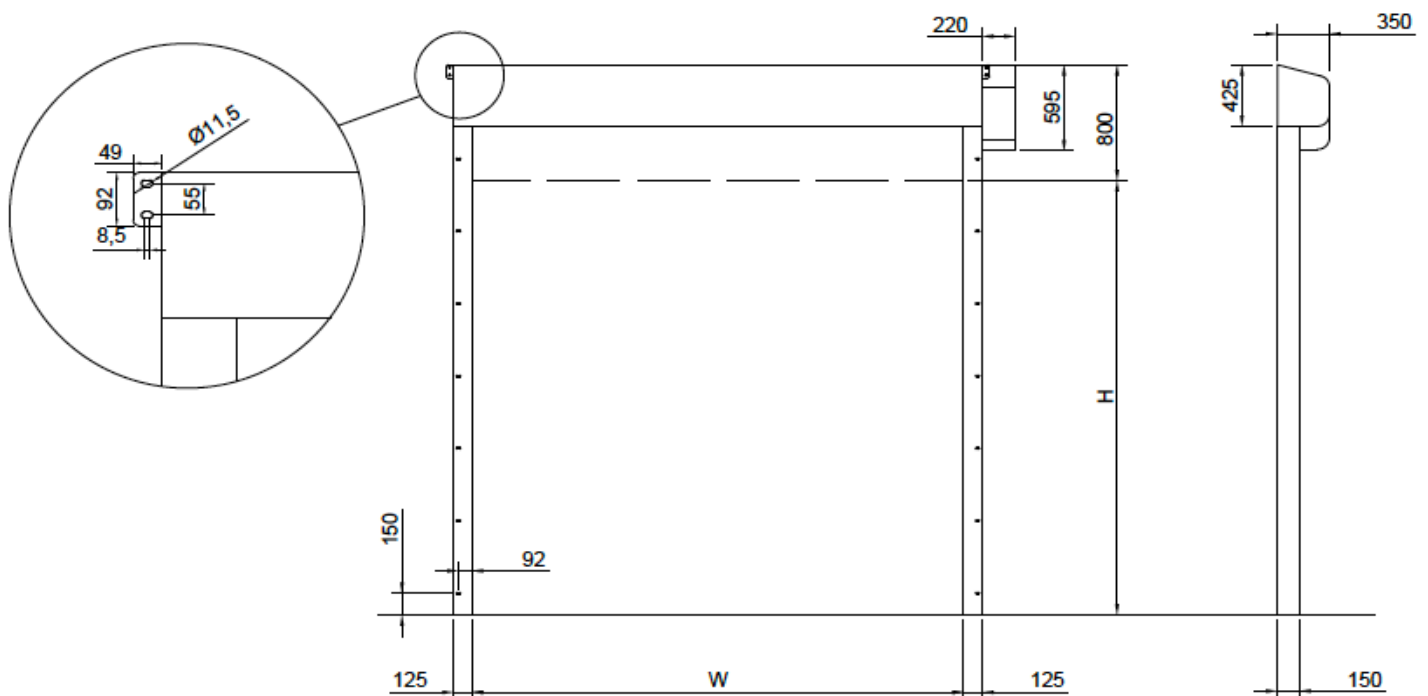



# PVC CHARACTERISTICS

## STANDARD PVC

### Composition and tests

EXTERNAL SIDE			
Material	Finishing	Color	Thick
PVC	Opaque	18 standard	0,7 mm
FABRIC			
Material	N. tarps	Title	EN 2286-2
PES	1	1100Dtex 12x12	900 g/m <sup>2</sup>
INTERNAL SIDE			
Material	Finishing	Color	Thick
PVC	Rough	18 standard	0,2 mm
<b>COLD RESISTANCE</b> ISO 4675/90 -50°C ±5			
<b>HYDROLYSIS TEST</b> 75°C 95% humidity none variation			
<b>GAS OIL TEST</b> -			
<b>MARINE WATER TEST</b> none variation			
<b>OZONE TEST</b> ISO 3011 none crack			
<b>T. STORAGE</b> (°C) -30 +65			
<b>FLAME TEST</b> ISO 3795 < 100 mm/min			
<b>PERFORATION</b> RINA 3.A1.2.7 (N) > 100			
<b>EXERCISE 7 days -70°C</b> ISO 6065 none variation			

### Characteristics

<b>THICK</b> ISO 2286/3 (mm) 0,9±0,1
<b>WEIGHT</b> ISO 2286/2 (kg/m <sup>2</sup> ) 0,90±0,1
<b>LOAD BREAK</b> ISO 1421 6000 N/50mm
<b>WARP EXTENSION</b> ISO 1421 4300 N/50mm
<b>TEXTURE EXTENSION</b> ISO 1421 4000 N/50mm
<b>WARP BREAK</b> dIN 53363 (N) > 600
<b>TEXTURE BREAK</b> dIN 53363 (N) > 530
<b>ADHESION</b> dIN EN ISO 2411 130 N/50mm
<b>EEC CONFORMITY</b> - Yes
<b>SPECIFIC USE</b> industry, refrigerators, car washes, supermarkets, warehouses
<b>ASSOCIATION</b> -

### Colors



 Translucent  Antistatic available

## INSULATED PVC

### Composition and tests

EXTERNAL SIDE			
Material	Finishing	Color	Thick
PVC	Straight	6 standard	0,5 mm
FABRIC			
Material	N. tarps	Title	EN 2286-2
PES	1	1100Dtex 12x12	1350 g/m <sup>2</sup>
INTERNAL SIDE			
Material	Finishing	Color	Thick
PVC	Sponge	6 standard	7 mm
<b>COLD RESISTANCE</b> ISO 4675/90 -10°C ±5			
<b>HYDROLYSIS TEST</b> 75°C 95% humidity none variation			
<b>GAS OIL TEST</b> -			
<b>MARINE WATER TEST</b> none variation			
<b>OZONE TEST</b> ISO 3011 none crack			
<b>T. STORAGE</b> (°C) -30 +65			
<b>FLAME TEST</b> ISO 3795 cl 2, NFPA 701 test 2			
<b>PERFORATION</b> RINA 3.A1.2.7 (N) > 100			
<b>EXERCISE 7 days -70°C</b> ISO 6065 none variation			

### Characteristics

<b>THICK</b> ISO 2286/3 (mm) 7,0±0,1
<b>WEIGHT</b> ISO 2286/2 (kg/m <sup>2</sup> ) 1,7±0,1
<b>LOAD BREAK</b> ISO 1421 6000 N/50mm
<b>WARP EXTENSION</b> ISO 1421/V1 3000 N/50mm
<b>TEXTURE EXTENSION</b> ISO 1421/V1 2800 N/50mm
<b>WARP BREAK</b> dIN 53363 300 N
<b>TEXTURE BREAK</b> dIN 53363 300 N
<b>ADHESION</b> PA 09.03 (internal) 15 N/cm
<b>THERMAL CONDUCTIVITY</b> -
0,03782 W.m <sup>-1</sup>
<b>ISOLATION INDEX</b> -
Rw= 17,5 dB
<b>EMPLOYMENT</b> industry, refrigerators, car washes, supermarkets, warehouses
<b>ASSOCIATION</b> -

### Colors

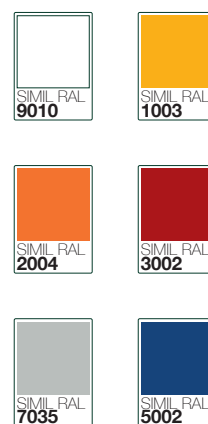

# CRISTAL CHARACTERISTICS

## PVC SUPERCLEAR

**! SUITABLE ONLY FOR POSITIVE TEMPERATURE ENVIRONMENTS**

### WINDOWS - CRISTAL TECHNICAL DATA

Article	SUPERCLEAR 0.75 mm FR
---------	-----------------------

Technical specifications	Standards	Unit	Values
Thickness	-	mm.	0.75
PVC total weight	-	g/m <sup>2</sup>	940
Light transmission	JIS K - 7361	%	87.5
Tensile strength <i>Lengthwise MD</i>	JIS K - 6732	N	26.6
Tensile strength <i>Crosswise TD</i>	JIS K - 6732	N	24.2
Tear strength <i>Lengthwise MD</i>	JIS K - 6732	N	55.6
Tear strength <i>Crosswise TD</i>	JIS K - 6732	N	57.4
Elongation <i>Lengthwise MD</i>	JIS K - 6732	%	406
Elongation <i>Crosswise TD</i>	JIS K - 6732	%	414
Cold crack resistance	JIS K - 6772	°C	-40
Flame retardancy	-	-	No
Hardness	-	-	4.0S
Standard length	-	m	30
Standard width	-	m	1.37

## FDA CERTIFICATED PVC

Food Drug Administration

### TECHNICAL DATA

#### Composition and tests

TOP FACE COATING			
Material	Finish	Color	Thickness
PUR	Opaque	White	0,6 mm
FABRIC			
Material	N. tarps	Title	EN 2286-2
PET	1	2200 Dtex 12x12	1500 g/m <sup>2</sup>
UNDERSIDE COATING			
Material	Finish	Color	Thickness
PUR	Plain	White	0,6 mm
COLD RESISTANCE			
ISO 4675/90 -30°C ±5			
TROPICAL TEST			
75°C 95% humidity none variation			
DIESEL FUEL TEST			
- none variation			
SEA WATER TEST			
- none variation			
OZONE TEST			
ISO 3011 none crack			
T. STORAGE			
(°C) -30 +65			
ABRASION			
ISO 5470/80, 5N C517 400 cycles (mg) 1			
PUNCTURE			
RINA 3.A1.2.7 (N) > 125			
EXERCISE 7 days -70°C			
ISO 6065 none variation			

#### Characteristics

THICKNESS	
ISO 2286/3 (mm) 1,20±0,1	
WEIGHT	
ISO 2286/2 (kg/m <sup>2</sup> ) 1,30±0,1	
TENSILE STRENGTH WARP	
ISO 1421 6000 N / 50mm	
ELONGATION YARN	
ISO 1421 [%] > 14	
ELONGATION WEFT	
ISO 1421 [%] > 20	
TEAR RESISTANCE WARP	
dIN 53363 (N) > 250	
TEAR RESISTANCE WEFT	
dIN 53363 (N) > 220	
PEELING TEST	
dIN EN ISO 2411 130 N/50mm	
FDA COMPLIANCE CEE	
Yes	
SPECIFIC USE	
cleanrooms, clinical, hospital	
ASSOCIATION	
<b>DynamicRoll</b>	

#### Disclaimer

The information contained in this document describes the features of the BMP EUROPE product as tested in a laboratory, other indications excepted, environment at a temperature of +23 degrees °C at 50% relative humidity. It does not necessarily reflect the conditions of industrial use and it does not guarantee the product to be suitable for certain applications. The client remains liable for the proper selection and correct use of the BMP EUROPE product. BMP EUROPE cannot be held responsible should damages arise from the use of its products. Necessary alterations to this data can be made without prior notice.

# OPTIONAL ACCESSORIES



## RADAR



OPENING POINTING RADAR  
TOF/SPOT  
for internal use only



INFRARED RADAR  
with cross-movement  
adjustment



INFRARED RADAR  
motion and presence  
(pedestrian/forklift) radar

## TRAFFIC LIGHTS



GREEN FIXED STANDARD  
traffic light



RED FIXED STANDARD  
traffic light



LED TRAFFIC LIGHT  
with countdown

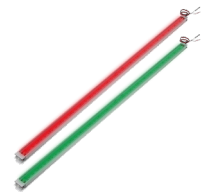

LED TRAFFIC LIGHT BARRIERS  
(connection card included)

## BUTTONS



OPENING GREEN BUTTON  
with box



OPENING BLACK BUTTON  
with box



FREEZE STOP BUTTON  
with box



NO TOUCH BUTTON



TRAFFIC LIGHT BUTTON  
DUAL-FUNCTION  
opening and  
intermittent door  
opening/closing  
signaling

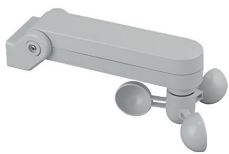

WIND GAUGE



KEY SELECTOR



REMOTE CONTROL



BOLLARD B-PROTECT



PULL CORD SWITCH



MAGNETIC LOOP DETECTOR

