

## STAIRCASE TOWER

### Description

A staircase tower design requires the staircase run to be divided equally. If the staircase rise is higher than 12', a mid-landing is required in which case both runs must be the exact same length. Bracing of the staircase tower is required, refer to Cogan Engineer to determine the bracing design of your staircase tower project.

All self-closing safety gates are sealed in a durable, powder-coated safety yellow paint finish for maximum visibility.

**w.w.Cannon, Inc.**

Design. Layout. Build. Install.

1-800-442-3061  
www.wwcannon.com

## PRODUCT INFORMATION

### Specifications

Design Requirement      Staircase run are divide equally

Mid-Landing                  If staircase rise is higher than 12'

#### COLORS



Cogan Grey  
(Guard, Stringers,  
Columns, Beams and  
Handrail Posts)

Electro-Galvanized  
(Tread, Closed Risers  
and Handrails)

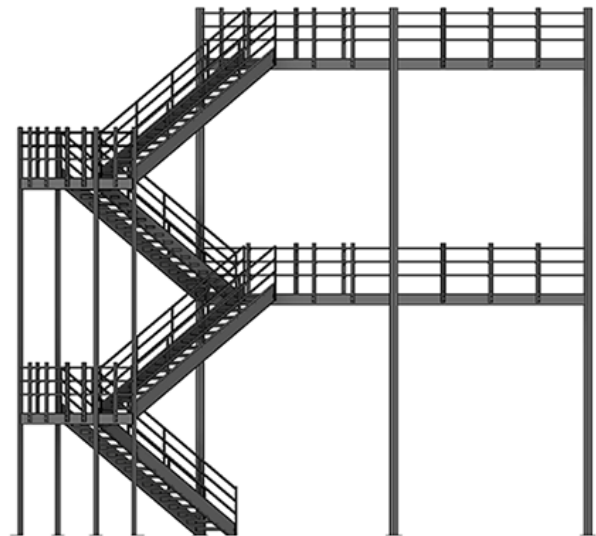



**Cogan**  
Since 1901



**Mezzanines**  
Increase Floor Space

cogan.com

# STAIRCASES

## DETAILS

