



# Model DG

## Locking Type

The Model DG rail clamp is used for lifting and transporting crane rails and railroad rails. Lightness of weight allows it to be hand applied and hand removed. The Model DG possesses all the features of the Model FR. All the repair parts are identical to same tonnage of the FR, except the swivel jaw has been eliminated.



The best choice for lifting crane rails and railroad rails.

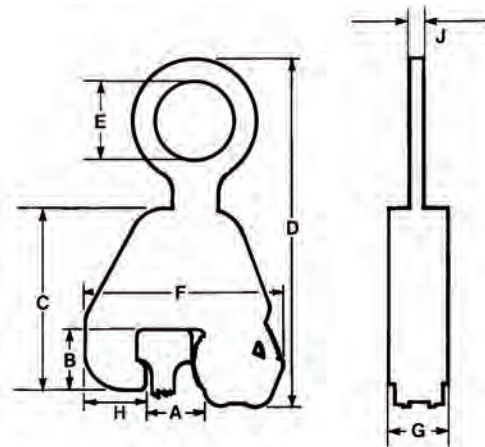
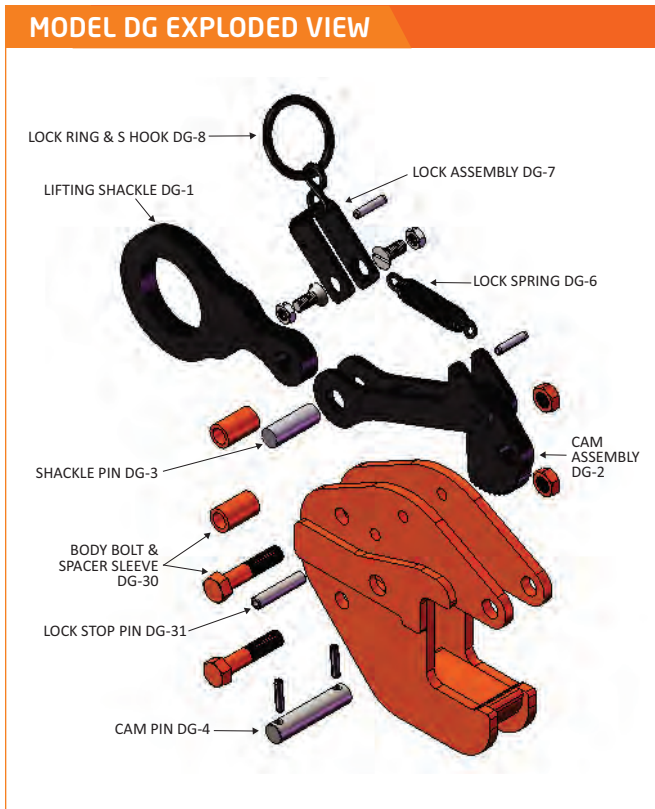

### MODEL DG SPECIFICATIONS (in inches)

Part Number	Model	Capacity Standard Rail A (lbs.)	Capacity Crane Rail A (lbs.)	B	C	D	E	F	G	H	J	Weight (lbs.)
<b>1/2 Tons Capacity</b>												
DG-00.50-A	25	12 – 25	–	1-5/16	6-11/16	11-1/4	2-3/8	5-3/8	2-1/2	1-5/8	1/2	10
DG-00.50-B	50	30 – 50	–	1-3/8	6-11/16	11-1/4	2-3/8	6	2-1/2	1-5/8	1/2	11
<b>1 Tons Capacity</b>												
DG-01.00-A	132	85 – 155	–	2-1/2	8-1/8	13-1/2	2-5/8	8-5/8	3-1/4	1-7/8	5/8	16
<b>2 Tons Capacity</b>												
DG-02.00-A	105	60 – 155	104 & 105	2-5/8	9	16	3-5/8	9-1/8	3-1/4	2-1/2	3/4	26
DG-02.00-B	175	–	135, 171, 175	2-5/8	9-1/2	16	3-5/8	10-3/8	3-1/4	2-1/2	3/4	26

Consult factory for possible larger capacities. SPECIFICATIONS ARE SUBJECT TO CHANGE WITHOUT NOTICE.