



Model AST

Non-Locking Type

Both the **Model AST and ASTL** were developed primarily for lifting, turning and stacking lightweight beams and structural shapes while a constant tension is applied to the lifting shackle. The horizontal shackle permits a beam to be lifted with the web in a near horizontal position by placing the clamp on the load with the shackle positioned over the web, and between the flanges. With a beam lying in a horizontal position, and the clamp placed with the shackle overhanging the flange, the beam can be lifted, turned 90°, and raised in a vertical position.

Permits beam to be lifted in a near horizontal position.

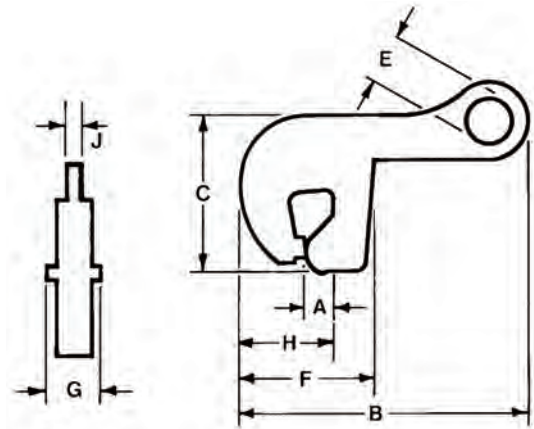

MODEL AST SPECIFICATIONS (in inches)

Part Number	Plate Thickness A	Max. B	C	D	E	F	G	H	J	Weight (lbs.)
1/2 Tons Capacity										
AST-00.50-A	0 – 3/4	10-3/4	6-11/16	–	1-3/4	6-3/16	1-5/8	2-1/2	1/2	10
1-1/2 Tons Capacity										
AST-01.50-A	0 – 3/4	13	8-1/2	–	2-1/2	7	2-9/16	3	5/8	20
3 Tons Capacity										
AST-03.00-A	0 – 1-1/2	19-1/4	12-1/2	–	3-3/4	11	3	4-5/8	3/4	50

Consult factory for possible larger capacities. SPECIFICATIONS ARE SUBJECT TO CHANGE WITHOUT NOTICE.

IN STOCK