

Model TL

Locking Type

The **Model TL** is a vertical lifting clamp capable of turning a single plate or member from horizontal to vertical and back to horizontal through the same 90° arc. The “Lock Open – Lock Closed” feature facilitates attaching and removing the clamp from the plate.



Used in places you'd use the Model J, but it has a serrated cam jaw that only pivots back and forth. Better for less bumpy lifts.

MODEL TL EXPLODED VIEW

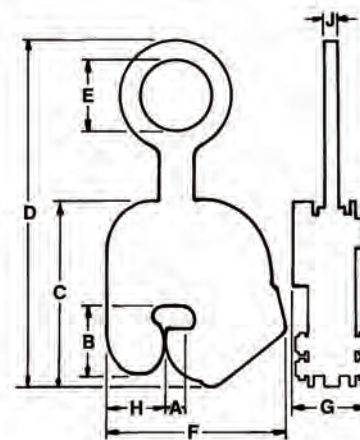
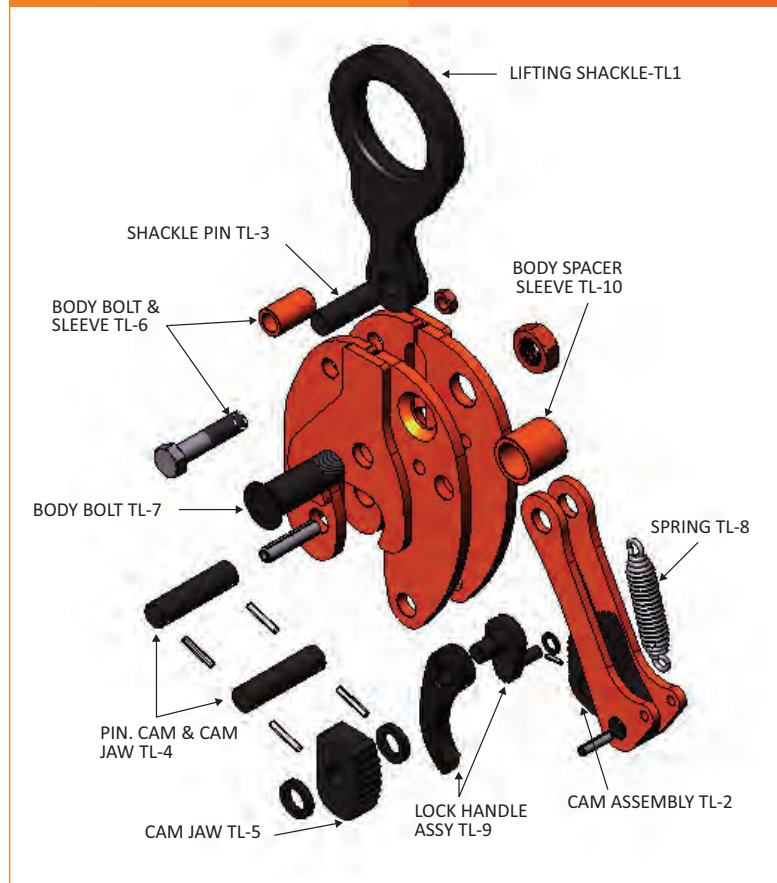

Manuals Now Online

No need to ever worry about misplacing your RENFROE Operator Manuals again ... they're all online! Let's face it ... employees turn over. Safety files get misplaced. Now, no one needs to worry because the Operator Manuals that contain proper inspection, maintenance and use instructions for each clamp live on the caldwellinc.com website with 24/7 access for anyone.

Go to caldwellinc.com now and search for your clamp model (i.e. Model TL) to find the manual.



MODEL TL SPECIFICATIONS (in inches)

Part Number	Plate Thickness A	B	C	Max. D	E	Max. F	G	H	J	Weight (lbs.)
1/2 Tons Capacity										
IN STOCK TL-00.50-A	0 – 5/8	2-3/8	6-1/4	11-1/8	2-3/8	4-3/4	2-3/4	1-13/16	1/2	9
TL-00.50-B	1/2 – 1	2-3/8	6-1/4	11-1/8	2-3/8	5-1/8	2-3/4	1-13/16	1/2	10
TL-00.50-C	3/4 – 1-1/4	2-3/8	6-1/4	11-1/8	2-3/8	5-3/8	2-3/4	1-13/16	1/2	11
TL-00.50-D	1-1/4 – 1-3/4	2-3/8	6-1/4	11-1/8	2-3/8	5-7/8	2-3/4	1-13/16	1/2	13
1 Tons Capacity										
IN STOCK TL-01.00-A	0 – 3/4	3	7-1/2	13-1/8	2-7/16	6	2-13/16	2	5/8	14
TL-01.00-B	1/2 – 1	3	7-1/2	13-1/8	2-7/16	6-1/4	2-13/16	2	5/8	15
TL-01.00-C	3/4 – 1-1/4	3	7-1/2	13-1/8	2-7/16	6-1/2	2-13/16	2	5/8	16
TL-01.00-D	1 – 1-1/2	3	7-1/2	13-1/8	2-7/16	6-3/4	2-13/16	2	5/8	17
TL-01.00-E	1-1/2 – 2	3	7-1/2	13-1/8	2-7/16	7-1/4	2-13/16	2	5/8	18
2 Tons Capacity										
TL-02.00-A	0 – 1	3-1/2	9-3/8	16-1/4	3-5/8	8-7/8	3-3/4	2-7/8	3/4	32
TL-02.00-B	3/4 – 1-1/2	3-1/2	9-3/8	16-1/4	3-5/8	9-3/8	3-3/4	2-7/8	3/4	33
TL-02.00-C	1-1/4 – 2	3-1/2	9-3/8	16-1/4	3-5/8	9-7/8	3-3/4	2-7/8	3/4	35
TL-02.00-D	2 – 2-3/4	3-1/2	9-3/8	16-1/4	3-5/8	10-5/8	3-3/4	2-7/8	3/4	37
4 Tons Capacity										
TL-04.00-A	3/16 – 1-1/4	4	9-7/8	17-5/8	3-5/8	9	3-13/16	3	3/4	36
TL-04.00-B	1 – 2	4	9-7/8	17-5/8	3-5/8	9-3/4	3-13/16	3	3/4	37
TL-04.00-C	2 – 3	4	9-7/8	17-5/8	3-5/8	10-3/4	3-13/16	3	3/4	40
TL-04.00-D	3 – 4	4	9-7/8	17-5/8	3-5/8	11-3/4	3-13/16	3	3/4	43
6 Tons Capacity										
TL-06.00-A	1/4 – 1-3/8	4-5/8	11-1/8	20-1/8	3-1/2	10-1/4	3-7/8	3-3/8	3/4	49
TL-06.00-B	1 – 2-1/8	4-5/8	11-1/8	20-1/8	3-1/2	11	3-7/8	3-3/8	3/4	51
TL-06.00-C	2 – 3-1/8	4-5/8	11-1/8	20-1/8	3-1/2	12	3-7/8	3-3/8	3/4	54
TL-06.00-D	3 – 4-1/8	4-5/8	11-1/8	20-1/8	3-1/2	13	3-7/8	3-3/8	3/4	57
8 Tons Capacity										
TL-08.00-A	3/8 – 1-1/2	4-13/16	12-5/16	21-5/16	3-3/4	11-1/2	4-3/4	3-7/8	1	72
TL-08.00-B	1 – 2-1/8	4-13/16	12-5/16	21-5/16	3-3/4	12-1/8	4-3/4	3-7/8	1	74
TL-08.00-C	2 – 3-1/8	4-13/16	12-5/16	21-5/16	3-3/4	13-1/8	4-3/4	3-7/8	1	77
TL-08.00-D	3 – 4-1/8	4-13/16	12-5/16	21-5/16	3-3/4	14-1/8	4-3/4	3-7/8	1	80
12 Tons Capacity										
TL-12.00-A	1/2 – 2-1/2	6-1/4	15-1/8	26-3/16	3-7/8	14-1/2	6-3/4	4-3/8	1-3/4	142
TL-12.00-B	2 – 4	6-1/4	15-1/8	26-3/16	3-7/8	16	6-3/4	4-3/8	1-3/4	150
TL-12.00-C	3 – 5	6-1/4	15-1/8	26-3/16	3-7/8	17	6-3/4	4-3/8	1-3/4	154
TL-12.00-D	4 – 6	6-1/4	15-1/8	26-3/16	3-7/8	18	6-3/4	4-3/8	1-3/4	158
20 Tons Capacity										
TL-20.00-A	1/2 – 3	8-1/8	21-3/4	36-11/16	5	20-11/16	8-1/16	6-3/16	2-3/4	415
TL-20.00-B	2-1/2 – 4-1/2	8-1/8	21-3/4	36-11/16	5	22-3/16	8-1/16	6-3/16	2-3/4	426
TL-20.00-C	3 – 5	8-1/8	21-3/4	36-11/16	5	22-11/16	8-1/16	6-3/16	2-3/4	430
TL-20.00-D	5 – 7	8-1/8	21-3/4	36-11/16	5	24-11/16	8-1/16	6-3/16	2-3/4	445

Consult factory for possible larger capacities. SPECIFICATIONS ARE SUBJECT TO CHANGE WITHOUT NOTICE.

All Model TL clamps can be built as Model TLH clamps for use in extreme high-temperature situations. Please consult your Caldwell sales representative to learn more at 800.628.4263.