

Model J

Locking Type

The Model J is a vertical lifting clamp capable of turning a single plate or member from horizontal to vertical and back to horizontal through the same 90° arc.

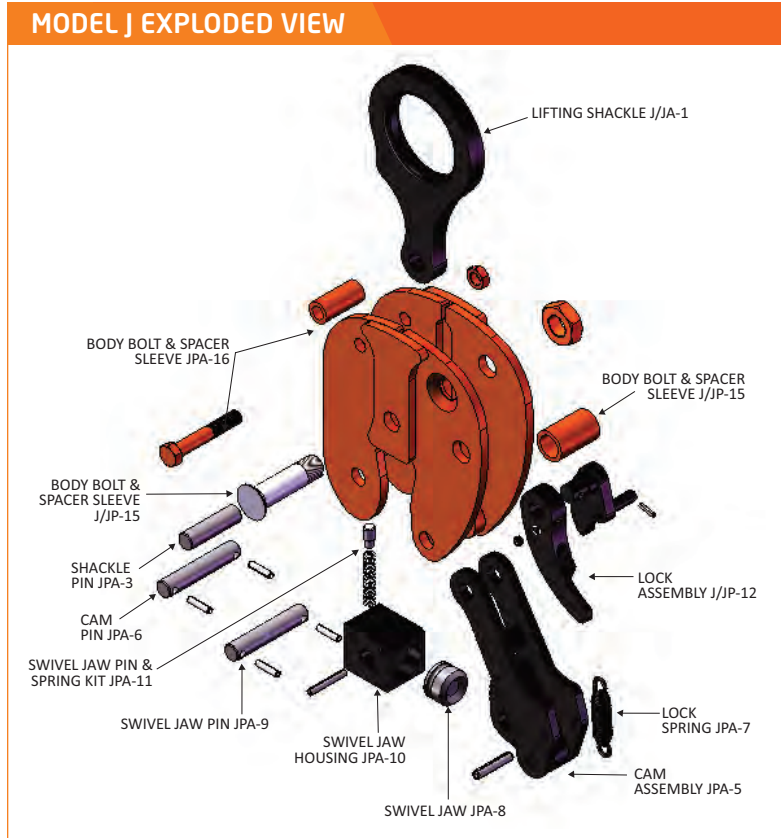

Round swivel jaw clamp pivots when lift is bumpy to prevent plate from walking off.



Let Freedom Ring!

While the Founding Fathers probably spent little to no time thinking about safe lifting practices, the people who needed to move the Liberty Bell surely did ... and they called on RENFROE to help. The Liberty Bell has been moved twice, once in 1976 and again in 2003 and both times custom-designed RENFROE clamps were part of the process.

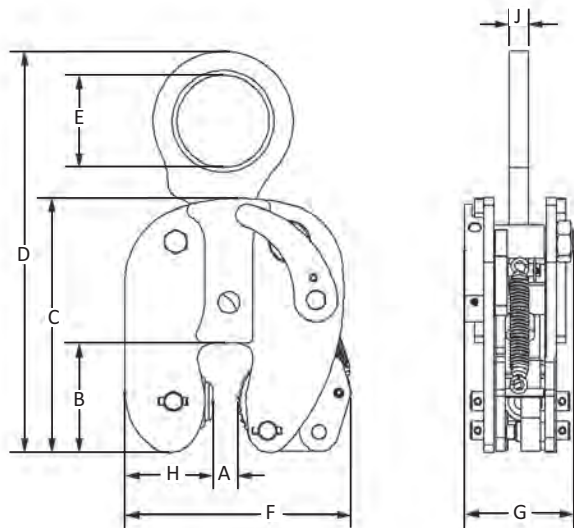

MODEL J SPECIFICATIONS (in inches)

Part Number	Plate Thickness A	B	C	Max. D	E	F	G	H	J	Weight (lbs.)
1/2 Tons Capacity										
J-00.50-A	0 – 5/8	2-3/4	6-1/2	12	2-3/8	5-5/8	3-1/4	2-1/4	1/2	10
J-00.50-B	1/2 – 1	2-3/4	6-1/2	12	2-3/8	6	3-1/4	2-1/4	1/2	
J-00.50-C	3/4 – 1-1/4	2-3/4	6-1/2	12	2-3/8	6-1/4	3-1/4	2-1/4	1/2	
J-00.50-D	1-1/4 – 1-3/4	2-3/4	6-1/2	12	2-3/8	6-3/4	3-1/4	2-1/4	1/2	
1 Tons Capacity										
J-01.00-A	0 – 3/4	3-3/8	7-3/4	13-3/4	2-7/16	7	3-1/2	2-5/8	5/8	15
J-01.00-B	1/2 – 1	3-3/8	7-3/4	13-3/4	2-7/16	7-1/4	3-1/2	2-5/8	5/8	
J-01.00-C	3/4 – 1-1/4	3-3/8	7-3/4	13-3/4	2-7/16	8	3-1/2	2-5/8	5/8	
J-01.00-D	1 – 1-1/2	3-3/8	7-3/4	13-3/4	2-7/16	8-1/4	3-1/2	2-5/8	5/8	
J-01.00-E	1-1/2 – 2	3-3/8	7-3/4	13-3/4	2-7/16	8-3/4	3-1/2	2-5/8	5/8	
2 Tons Capacity										
J-02.00-A	0 – 1	3-5/8	9-1/2	17-3/8	3-1/2	8-3/4	4-1/2	3	3/4	36
J-02.00-B	3/4 – 1-1/2	3-5/8	9-1/2	17-3/8	3-1/2	9-1/4	4-1/2	3	3/4	
J-02.00-C	1-1/4 – 2	3-5/8	9-1/2	17-3/8	3-1/2	9-3/4	4-1/2	3	3/4	
J-02.00-D	2 – 2-3/4	3-5/8	9-1/2	17-3/8	3-1/2	10-1/2	4-1/2	3	3/4	
4 Tons Capacity										
J-04.00-A	3/16 – 1-1/4	4-3/8	11-1/2	20-1/8	3-1/2	9-1/4	4-1/2	3-1/4	1-1/2	42
J-04.00-B	1 – 2	4-3/8	11-1/2	20-1/8	3-1/2	10	4-1/2	3-1/4	1-1/2	
J-04.00-C	2 – 3	4-3/8	11-1/2	20-1/8	3-1/2	11	4-1/2	3-1/4	1-1/2	
J-04.00-D	3 – 4	4-3/8	11-1/2	20-1/8	3-1/2	12	4-1/2	3-1/4	1-1/2	
6 Tons Capacity										
J-06.00-A	1/4 – 1-3/8	4-7/8	12-3/8	20-7/8	3-1/2	10-3/4	4-3/4	3-3/4	1-1/2	64
J-06.00-B	1 – 2-1/8	4-7/8	12-3/8	20-7/8	3-1/2	11-1/2	4-3/4	3-3/4	1-1/2	
J-06.00-C	2 – 3-1/8	4-7/8	12-3/8	20-7/8	3-1/2	12-1/2	4-3/4	3-3/4	1-1/2	
J-06.00-D	3 – 4-1/8	4-7/8	12-3/8	20-7/8	3-1/2	13-1/2	4-3/4	3-3/4	1-1/2	
8 Tons Capacity										
J-08.00-A	3/8 – 1-1/2	5-3/8	12-3/4	22-5/8	3-3/4	12-3/8	5-1/4	4-1/4	2	83
J-08.00-B	1 – 2-1/8	5-3/8	12-3/4	22-5/8	3-3/4	13	5-1/4	4-1/4	2	
J-08.00-C	2 – 3-1/8	5-3/8	12-3/4	22-5/8	3-3/4	14-5/8	5-1/4	4-1/4	2	
J-08.00-D	3 – 4-1/8	5-3/8	12-3/4	22-5/8	3-3/4	15-5/8	5-1/4	4-1/4	2	
12 Tons Capacity										
J-12.00-A	1/2 – 2-1/2	7-1/4	17-3/8	28-1/8	3-7/8	15-15/16	7-1/16	5-3/8	2	203
J-12.00-B	2 – 4	7-1/4	17-3/8	28-1/8	3-7/8	17-7/16	7-1/16	5-3/8	2	212
J-12.00-C	4 – 6	7-1/4	17-3/8	28-1/8	3-7/8	19-7/16	7-1/16	5-3/8	2	222
16 Tons Capacity										
J-16.00-A	1/2 – 2-1/2	8	19-13/16	32-5/16	4-1/2	19-13/16	8-11/16	6-1/4	2-1/4	350
20 Tons Capacity										
J-20.00-A	1/2 – 3	8-5/8	21-13/16	35-7/8	5	21	11-1/2	6-7/8	2-3/4	456
25 Tons Capacity										
J-25.00-A	1/2 – 2-1/2	8-5/8	23-5/8	35-7/8	5	19-1/16	9-5/8	6-3/4	3	483
J-25.00-B	3 – 5	8-5/8	23-5/8	35-7/8	5	21-9/16	9-5/8	6-3/4	3	495
J-25.00-C	4 – 6	8-5/8	23-5/8	35-7/8	5	22-9/16	9-5/8	6-3/4	3	502
30 Tons Capacity										
J-30.00-A	1/2 – 3	9-9/16	24-1/4	39-7/8	5	22-13/16	14-9/16	7-5/8	3	625
50 Tons Capacity										
J-50.00-A	3 – 5	10-7/8	30-7/8	46-7/16	5	29-3/16	11-1/8	9-1/4	3-1/2	1306

Consult factory for possible larger capacities. SPECIFICATIONS ARE SUBJECT TO CHANGE WITHOUT NOTICE.