



Model BD

Non-Locking Type

The **Model BD** is a vertical lifting, non-locking clamp used primarily for steel warehousing and bench work where a locking type clamp is not essential. The clamp is a low-cost, low-maintenance tool that features lightweight and compact size. It is recommended for use and application where constant tension is applied to the lifting shackle throughout the entire operation.



Non-locking, affordable, low-maintenance.

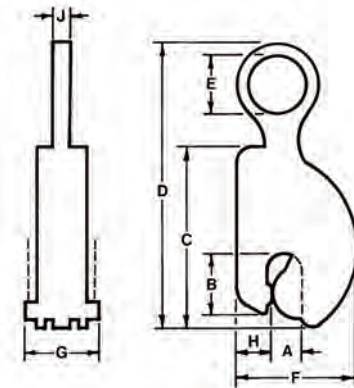
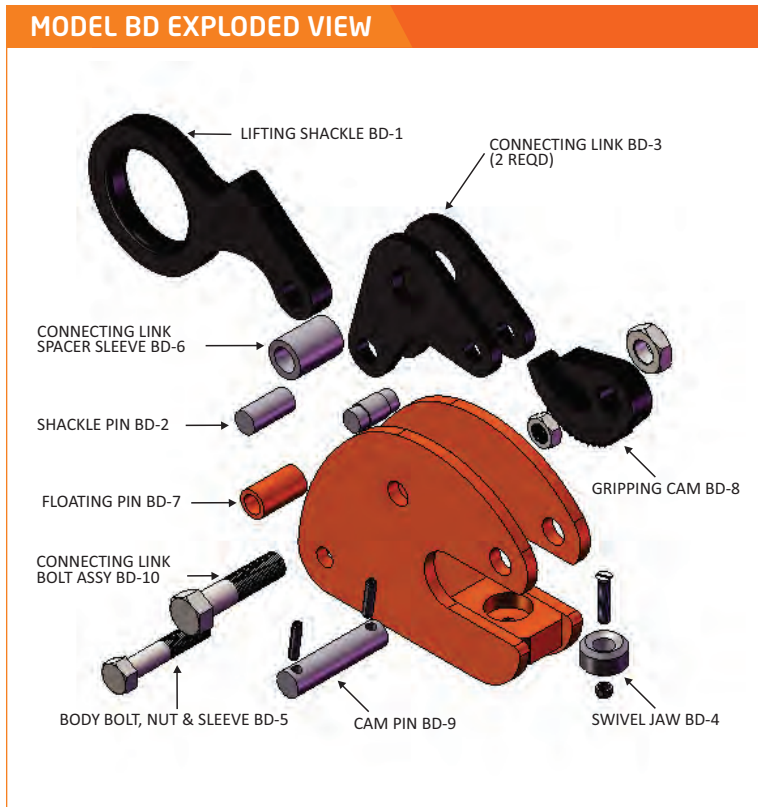

MODEL BD SPECIFICATIONS (in inches)

Part Number	Plate Thickness A	B	C	D	E	F	G	H	J	Weight (lbs.)
1/2 Tons Capacity										
BD-00.50-A	0 - 1	2-9/16	6-5/16	10-3/8	1-3/4	4-1/2	2-1/4	1-3/8	1/2	6
1 Tons Capacity										
BD-01.00-A	0 - 1-1/8	3-1/16	7-5/16	12-3/4	2-1/2	5-9/16	2-7/8	1-5/8	5/8	11
2 Tons Capacity										
BD-02.00-A	0 - 1-3/8	3-9/16	8-1/16	14-1/2	3-1/8	6-9/16	3	2-1/4	5/8	16
4 Tons Capacity										
BD-04.00-A	0 - 1-3/4	3-7/8	10-3/4	17-3/4	3-1/8	7-7/16	3-7/8	2-1/4	3/4	27
7 Tons Capacity										
BD-07.00-A	1/4 - 2-1/2	5	12-3/4	22-1/2	3-7/8	9-5/8	5	3	1	65

Consult factory for possible larger capacities. SPECIFICATIONS ARE SUBJECT TO CHANGE WITHOUT NOTICE.

IN STOCK