

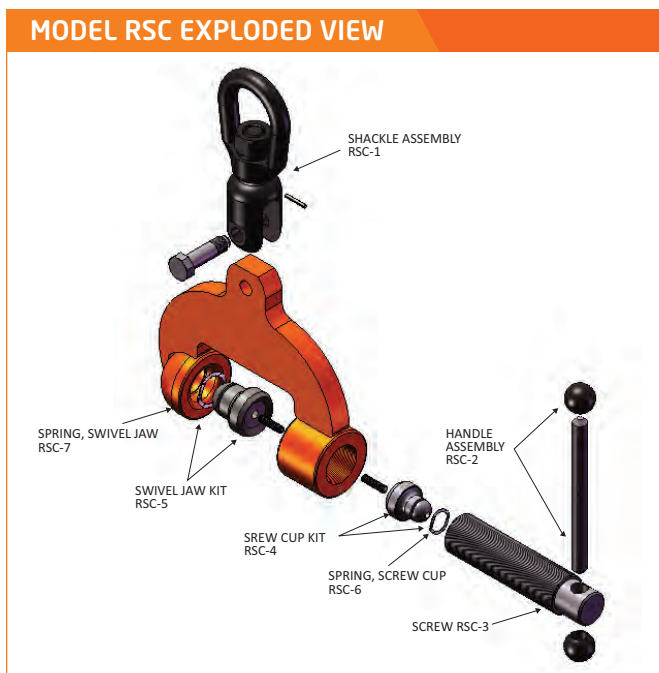

Model RSC

Locking, Screw Type

The Model RSC is a lightweight screw clamp for bench work on steel plates of large thickness, and weighing less than 1,000 lbs.



Lightweight and easier to handle for capacities up to 1/2-tons.

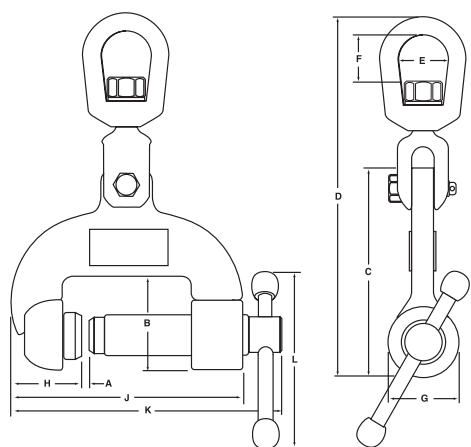

IN STOCK

Look for this icon to see which of the most popular clamps and sizes are in stock and ready to ship right now.

MODEL RSC SPECIFICATIONS (in inches)

Part Number	Plate Thickness A	B	C	D	E	F	G	H	J	K	L	Weight (lbs.)
1/2 Tons Capacity												
IN STOCK RSC-00.50-A	0 – 3	3-3/16	7	12-3/16	1-3/4	1-9/16	2-3/8	2-3/8	7-7/8	11-7/8	6-3/4	13.5
IN STOCK RSC-00.50-B	1-3/8 – 4-1/4	3-3/16	7-5/16	12-5/16	1-3/4	1-9/16	2-3/8	2-3/8	9-1/4	13-1/8	6-3/4	16.5

Consult factory for possible larger capacities. SPECIFICATIONS ARE SUBJECT TO CHANGE WITHOUT NOTICE.