



Model TLA

Locking Type

The Model TLA is a vertical lifting clamp incorporating a “Lock Open” and a “Lock Closed” feature and an auxiliary push button lock. The clamp is capable of turning a steel plate from horizontal to vertical to horizontal through a 180° arc. The “Lock Open,” “Lock Closed” feature facilitates attaching and removing the clamp from the plate.



Similar to the Model JA with a serrated cam jaw.

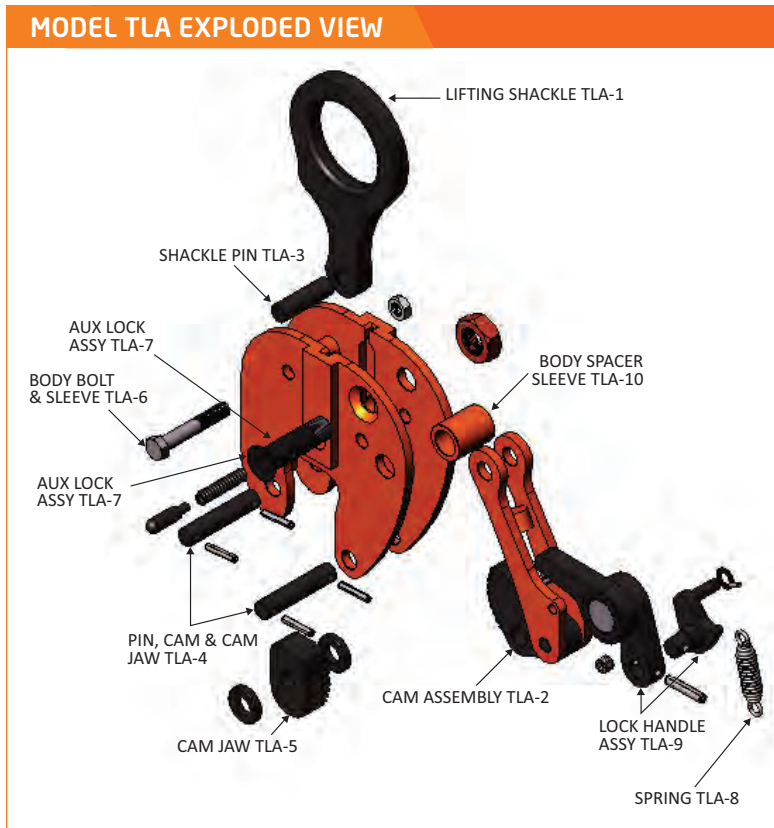



Not Seeing What You Need?

Sometimes a standard, off-the-shelf clamp just won't work. No worries! The Caldwell/RENFROE engineering team is on site at our Rockford, IL location, ready to help you get exactly what your lift requires. Sometimes you just need more capacity. Sometimes you're working with a specific shape. Rest assured we've seen it all.

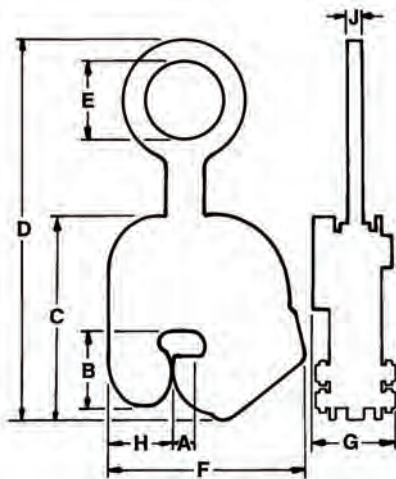
Call 800.628.4263 to get started.



MODEL TLA SPECIFICATIONS (in inches)

Part Number	Plate Thickness A	B	C	Max. D	E	Max. F	G	H	J	Weight (lbs.)
1/2 Tons Capacity										
TLA-00.50-A	0 – 5/8	2-3/8	6-1/4	11-1/8	2-3/8	4-3/4	2-3/4	1-13/16	1/2	9
TLA-00.50-B	1/2 – 1	2-3/8	6-1/4	11-1/8	2-3/8	5-1/8	2-3/4	1-13/16	1/2	10
TLA-00.50-C	3/4 – 1-1/4	2-3/8	6-1/4	11-1/8	2-3/8	5-3/8	2-3/4	1-13/16	1/2	11
TLA-00.50-D	1-1/4 – 1-3/4	2-3/8	6-1/4	11-1/8	2-3/8	5-7/8	2-3/4	1-13/16	1/2	13
1 Tons Capacity										
 TLA-01.00-A	0 – 3/4	3	7-1/2	13-1/8	2-7/16	6	2-13/16	2	5/8	14
TLA-01.00-B	1/2 – 1	3	7-1/2	13-1/8	2-7/16	6-1/4	2-13/16	2	5/8	15
TLA-01.00-C	3/4 – 1-1/4	3	7-1/2	13-1/8	2-7/16	6-1/2	2-13/16	2	5/8	16
TLA-01.00-D	1 – 1-1/2	3	7-1/2	13-1/8	2-7/16	6-3/4	2-13/16	2	5/8	17
TLA-01.00-E	1-1/2 – 2	3	7-1/2	13-1/8	2-7/16	7-1/4	2-13/16	2	5/8	18
2 Tons Capacity										
TLA-02.00-A	0 – 1	3-1/2	9-3/8	16-1/4	3-5/8	8-7/8	3-3/4	2-7/8	3/4	32
TLA-02.00-B	3/4 – 1-1/2	3-1/2	9-3/8	16-1/4	3-5/8	9-3/8	3-3/4	2-7/8	3/4	33
TLA-02.00-C	1-1/4 – 2	3-1/2	9-3/8	16-1/4	3-5/8	9-7/8	3-3/4	2-7/8	3/4	35
TLA-02.00-D	2 – 2-3/4	3-1/2	9-3/8	16-1/4	3-5/8	10-5/8	3-3/4	2-7/8	3/4	37
4 Tons Capacity										
TLA-04.00-A	3/16 – 1-1/4	4	9-7/8	17-5/8	3-5/8	9	3-13/16	3	3/4	36
TLA-04.00-B	1 – 2	4	9-7/8	17-5/8	3-5/8	9-3/4	3-13/16	3	3/4	37
TLA-04.00-C	2 – 3	4	9-7/8	17-5/8	3-5/8	10-3/4	3-13/16	3	3/4	40
TLA-04.00-D	3 – 4	4	9-7/8	17-5/8	3-5/8	11-3/4	3-13/16	3	3/4	43
6 Tons Capacity										
 TLA-06.00-A	1/4 – 1-3/8	4-5/8	11-1/8	20-1/8	3-1/2	10-1/4	3-7/8	3-3/8	3/4	49
TLA-06.00-B	1 – 2-1/8	4-5/8	11-1/8	20-1/8	3-1/2	11	3-7/8	3-3/8	3/4	51
TLA-06.00-C	2 – 3-1/8	4-5/8	11-1/8	20-1/8	3-1/2	12	3-7/8	3-3/8	3/4	54
TLA-06.00-D	3 – 4-1/8	4-5/8	11-1/8	20-1/8	3-1/2	13	3-7/8	3-3/8	3/4	57
8 Tons Capacity										
TLA-08.00-A	3/8 – 1-1/2	4-13/16	12-5/16	21-5/16	3-3/4	11-1/2	4-3/4	3-7/8	1	72
TLA-08.00-B	1 – 2-1/8	4-13/16	12-5/16	21-5/16	3-3/4	12-1/8	4-3/4	3-7/8	1	74
TLA-08.00-C	2 – 3-1/8	4-13/16	12-5/16	21-5/16	3-3/4	13-1/8	4-3/4	3-7/8	1	77
TLA-08.00-D	3 – 4-1/8	4-13/16	12-5/16	21-5/16	3-3/4	14-1/8	4-3/4	3-7/8	1	80
12 Tons Capacity										
TLA-12.00-A	1/2 – 2-1/2	6-1/4	15-1/8	26-3/16	3-7/8	14-1/2	6-3/4	4-3/8	1-3/4	142
TLA-12.00-B	2 – 4	6-1/4	15-1/8	26-3/16	3-7/8	16	6-3/4	4-3/8	1-3/4	150
TLA-12.00-C	3 – 5	6-1/4	15-1/8	26-3/16	3-7/8	17	6-3/4	4-3/8	1-3/4	154
TLA-12.00-D	4 – 6	6-1/4	15-1/8	26-3/16	3-7/8	18	6-3/4	4-3/8	1-3/4	158
20 Tons Capacity										
TLA-20.00-A	1/2 – 3	8-1/8	21-3/4	36-11/16	5	20-11/16	8-1/16	6-3/16	2-3/4	415
TLA-20.00-B	2-1/2 – 4-1/2	8-1/8	21-3/4	36-11/16	5	22-3/16	8-1/16	6-3/16	2-3/4	426
TLA-20.00-C	3 – 5	8-1/8	21-3/4	36-11/16	5	22-11/16	8-1/16	6-3/16	2-3/4	430
TLA-20.00-D	5 – 7	8-1/8	21-3/4	36-11/16	5	24-11/16	8-1/16	6-3/16	2-3/4	445

Consult factory for possible larger capacities. SPECIFICATIONS ARE SUBJECT TO CHANGE WITHOUT NOTICE.