

Model PCK-SL

Locking, Screw Type

The Model PCK-SL Locking Screw Clamp is a versatile multi-purpose lifting turning pulling clamp capable of lift and turn operations from the horizontal through 180° arc. The clamp can also be used for the assembling of steel plates, structural members and welded sections. The clamp is generally used in pairs for the purpose of drawing two plates or members together or to a predetermined position adjacent to each other. The adjusting screw is used to accommodate various thicknesses of material and to facilitate the attachment of the clamp to the member being worked on.



Features two lifting eyes so that you can reposition the lifting shackle to pull better.

MODEL PCK-SL EXPLODED VIEW

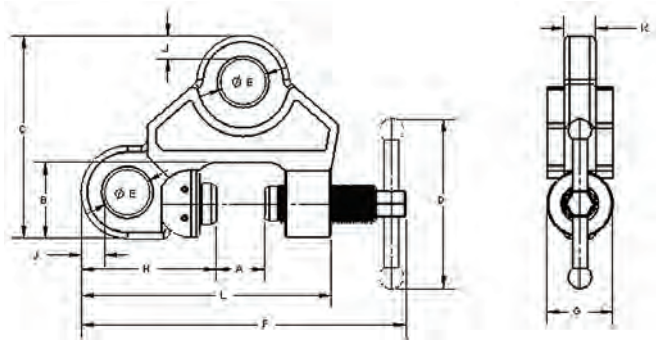
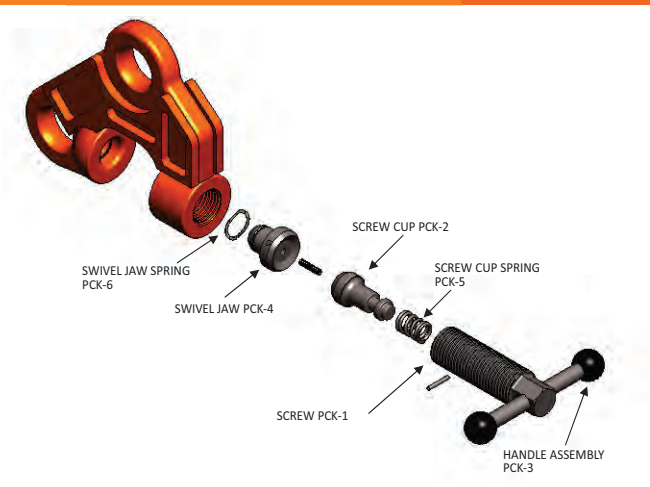

MODEL PCK-SL SPECIFICATIONS (in inches)

Part Number	Plate Thickness A	B	C	D	E	F	G	H	J	K	L	Weight (lbs.)
1/2 Tons Capacity												
PCK-SL-00.50-A	0 – 1	2-1/2	5-1/2	5-11/16	1	9-1/8	1-3/4	3	1/2	5/16	6-1/8	4.6
1 Tons Capacity												
PCK-SL-01.00-A	0 – 1-1/2	3	6-3/4	5-11/16	1-3/8	10-1/2	2-1/8	4-1/32	11/16	3/4	7-5/8	9.6
2 Tons Capacity												
PCK-SL-02.00-A	0 – 1-1/2	3-3/16	7-1/2	7	1-1/2	11-1/2	2-3/8	4-9/16	3/4	1	8-1/2	14.5
3 Tons Capacity												
PCK-SL-03.00-A	3/16 – 1-3/8	3-1/2	8	6-11/16	1-3/4	12-1/8	2-5/8	5-3/8	7/8	1-1/8	9-1/8	17.9
5 Tons Capacity												
PCK-SL-05.00-A	0 – 1-1/2	3-13/16	9-5/16	7-3/8	2	13-3/8	2-7/8	5-7/8	1	1-3/8	10	28.4

Consult factory for possible larger capacities. SPECIFICATIONS ARE SUBJECT TO CHANGE WITHOUT NOTICE.